

Low Insertion Force Female Contact

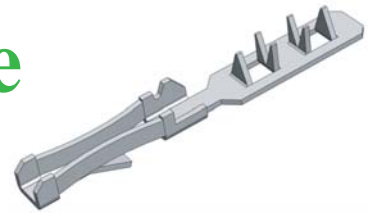

Designed for Crimping to Membrane Switches, Flexible Circuits, Jumper Cables, Sensors, Textile Ribbons etc

Suitable for use with MH Series Housings/Wafers

Low Insertion Force for Repeated Mating Cycles

2.54mm Pitch, Phosphor Bronze

Tin and Gold Plating as Standard, Others Available Upon Request

Contact your Local Office for Application/ Crimping Equipment

High Force Contact MHFC025 & High Flex Contact MHFFC106 also available

RoHS Compliant, Lead Free

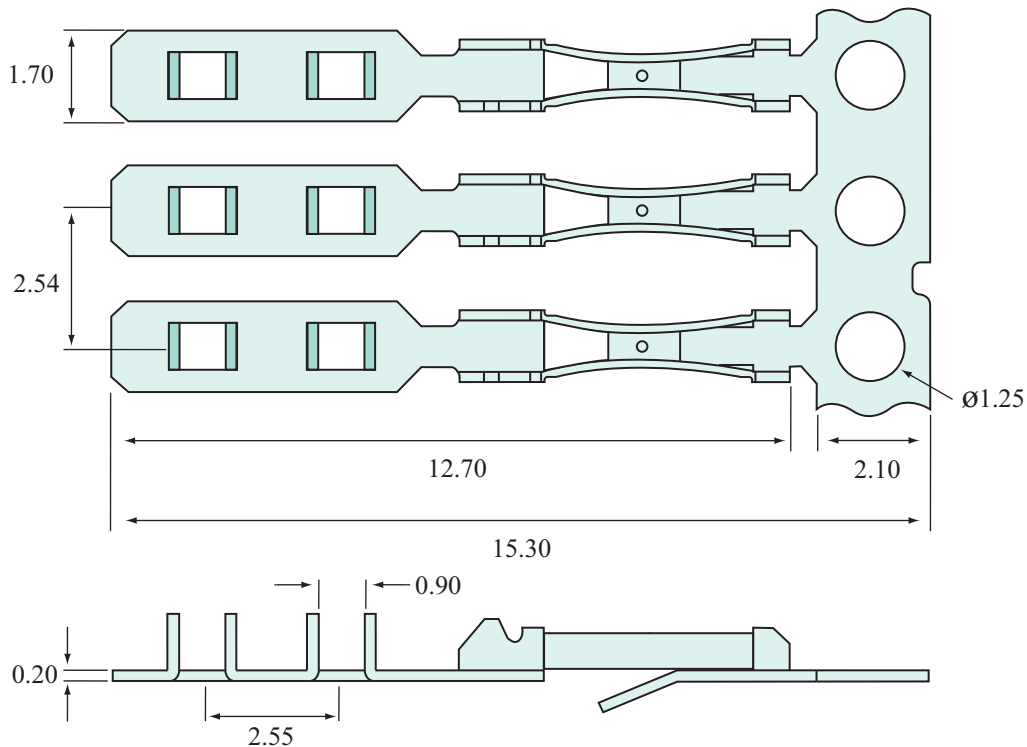

Unit : mm

Part Number	Description	Plating	Reel Quantity
MLFC506-T35	Low Insertion Force Female	Tin	35,000
MLFC506-SG35	Low Insertion Force Female	Selective Gold	35,000
MLFC506-G35	Low Insertion Force Female	Gold	35,000
OTHER PLATING AND REEL SIZES AVAILABLE ON REQUEST			

MEMCON Limited

Compass House Vision Park Chivers Way HISTON
Cambridge CB24 9AD United Kingdom
T +44 1223 257724 F +44 1223 257800
www.memcon.eu sales@memcon.eu

MEMCON (Asia) Limited

Level 7 Parkview Centre
7 Lau Li Street Causeway Bay Hong Kong
T +852 3741 1411 F +852 3747 8980
www.memcon.asia sales@memcon.asia